

PLAN VIEW  
SCALE 1:20

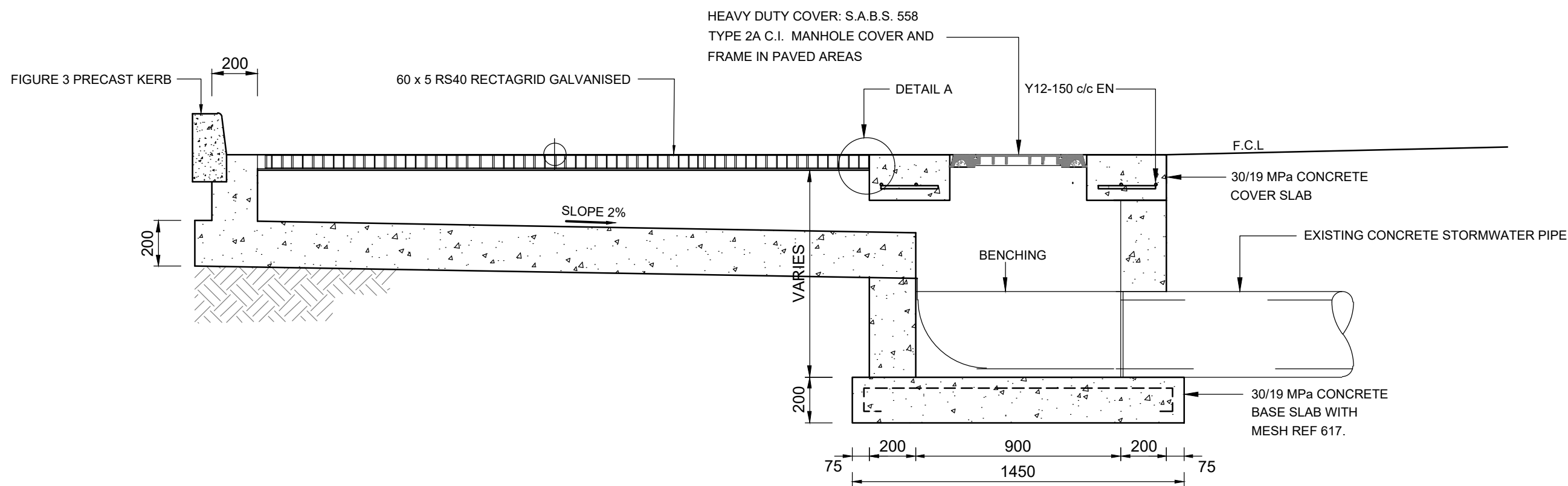

SECTION A-A  
SCALE 1:20

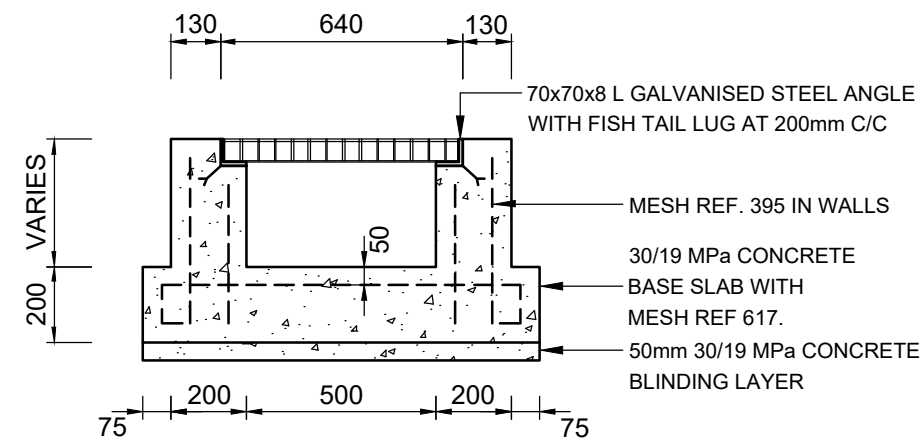

SECTION B-B  
SCALE 1:20

TYPICAL DETAIL FOR RECTAGRID TRENCH COVERS  
(AT ENTRANCE)

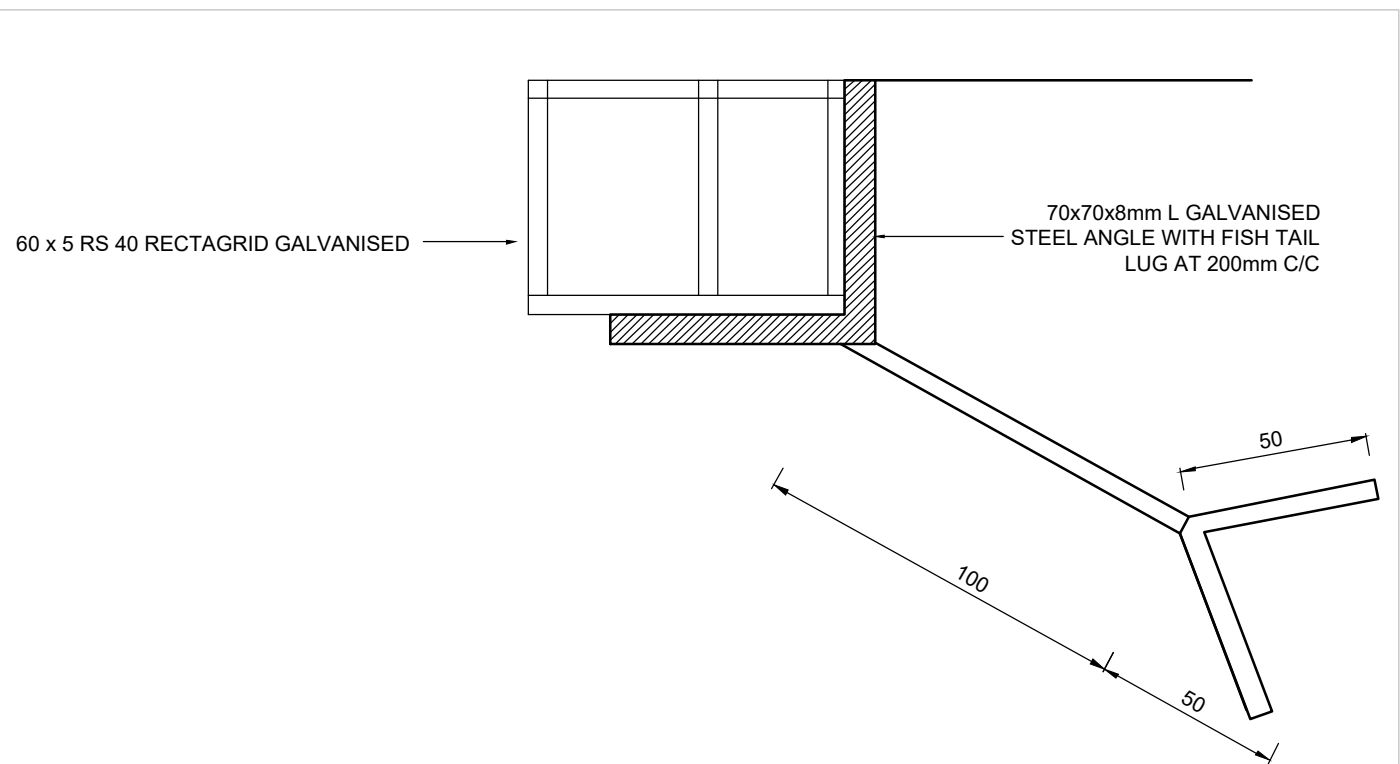

DETAIL A  
SCALE 1:2

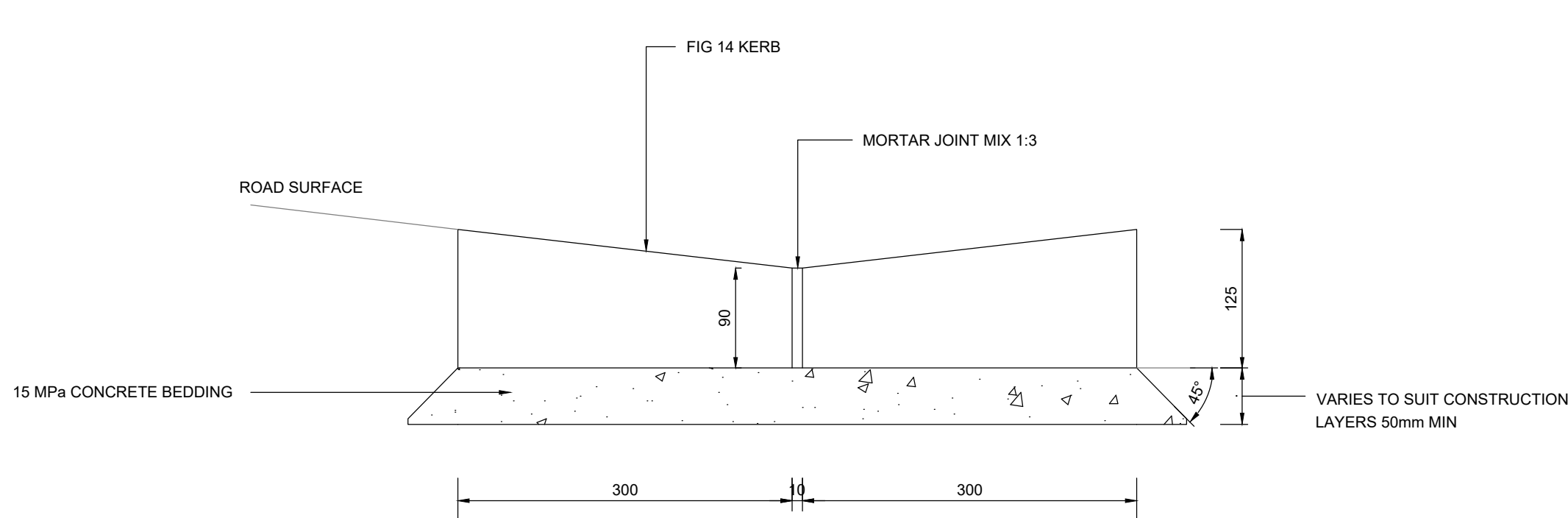

CHANNEL : TYPE C3  
SCALE 1:10

The design and content of this drawing is the property of Osmond Lange Architects and the copyright thereof is reserved by them.

- GENERAL NOTE
1. ALL STRUCTURAL, ELECTRICAL, CIVIL AND LANDSCAPING QUERIES ARE TO BE REFERRED TO THE RELEVANT CONSULTANTS DRAWINGS, SPECIFICATIONS AND DETAILS
  2. ALL PLUMBING QUERIES ARE TO BE REFERRED TO THE RELEVANT SPECIALIST CONSULTANTS DRAWINGS, SPECIFICATIONS AND DETAILS
  3. ALL CONCRETE, COLUMNS AND STRUCTURAL QUERIES ARE TO BE REFERRED TO P. STRUCTURAL ENGINEER'S DRAWINGS, SPECIFICATIONS AND DETAILS
  4. ALL EXTERNAL / INTERNAL WALLS REQUIRING BRACING / STIFFENING ARE TO BE CONSTRUCTED IN ACCORDANCE WITH P. STRUCTURAL ENGINEER'S DRAWINGS, SPECIFICATIONS AND DETAILS
  5. ALL SPECIFICATIONS WITH REGARD TO FIRE REGULATIONS, TO BE REFERRED TO CONSULTANTS DRAWINGS, SPECIFICATIONS AND DETAILS
  6. ALL DESIGN AND CONSTRUCTION TO COMPLY WITH THE RELEVANT SANS REGULATIONS
  7. ANY DISCREPANCY IN THE DRAWINGS, DIMENSIONS & SPECIFICATIONS TO BE BROUGHT TO THE ATTENTION OF THE CONSULTANT AND ARCHITECT PRIOR TO ANY WORK BEING PUT IN HAND
  8. ONLY FIGURED DIMENSIONS TO BE FOLLOWED - SCALED DIMENSIONS OF DRAWINGS WILL NOT BE PERMITTED

No	Date	Revision Description	By

PROJECT TEAM

Project Managers :  
Newground Projects : 17 St Andrews Road, Selborne, East London, 5201 043 722 5864  
Louis Fourie 0825768828  
Louis@newground.co.za

Principal Agent/ Architects :  
Osmond Lange Architects and Planners Pilot Mill House, The Quarry, Selborne East London (043) 721-0033  
William Martinson 083 3259600  
Williamm@o-l.co.za

Quantity Surveyors :  
Blisive Van Niekerk The Ridge Office Park, 2nd Floor 3 Berea Terrace, Berea, East London 043 721 1043  
Willem van Niekerk 0824921695  
willem@blisive.co.za

Civil & Structural Engineers :  
BVI Border 1st Floor, Esprit House, St Helena Drive East London, 5241  
043-722-2738  
Werner de Lange 082 578 0674  
WernerDL@bvi.co.za

Electrical & Mechanical Engineers :  
Evans Consulting Engineers cc 17 Surrey Road, Vincent, East London 5247  
043 7213192  
Darryl Evans 083 7026399  
darryl@evansconsulting.co.za

Town Planners :  
CS Consulting 12 Pearce Street, Harraway House Berea, East London 5241  
Craig Sam 0793267147  
Craig@csamconsulting.co.za

CLEINT  
east london idz  
business streamlines  
PO Box 5458, Greenfields East London, 5208  
Lower Chetler Road Sunningdale, 5201 East London, South Africa  
Tel: +27(0)437028200 Fax: +27(0)437064605 Email: info@elidz.co.za  
CLIENT APPROVAL :  
Gary Whittaker Project Manager Tel: 043 7026247 Cell: 082 34832299 Email: gary@elidz.co.za  
DATE :

TENANT

NAME :  
DESIGNATION :  
TENANT APPROVAL :  
DATE :

Project  
ELIDZ- ASP2 - HW1

Drawing Title  
BELLMOUTH ENTRANCE DRAINAGE DETAILS

Date	01.05.2019	Drawn	Author
Scale	AS SHOWN	Checked	Checker

Approved  
Name: Approver Reg No: PrArch5559  
Signature: Date:  
Practice: Osmond Lange Architects and Planners

Workstage  
FOR INFORMATION

Drawing Number	Revision
33722-HW1 - DET-14	